

Schottky Barrier Diode

FEATURES

- Low Forward Voltage Drop.
- Guard Ring Construction For Transient Protection.
- Negligible Reverse Recovery Time.
- Low Reverse Capacitance.

APPLICATIONS

- Schottky barrier switching.

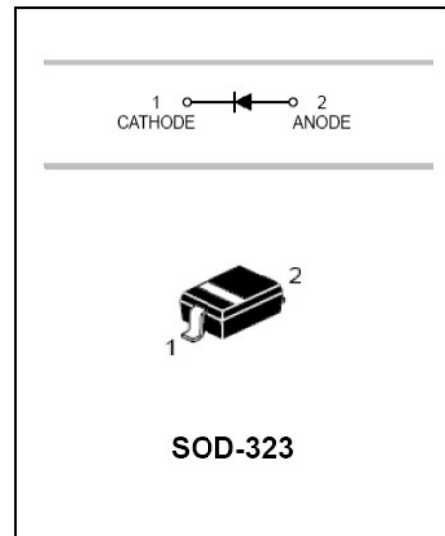

MAXIMUM RATING @ Ta=25°C unless otherwise specified

Parameter	Symbol		Unit
Peak Repetitive Peak reverse voltage	V_{RR}		
Working Peak DC Reverse Voltage	V_{RWM}	40	V
	V_R		
RMS Reverse Voltage	$V_{R(RMS)}$	28	V
Forward Continuous Current	I_F	500	mA
Repetitive Peak Forward Current @t≤1.0s	I_{FRM}	1.5	A
Power Dissipation	P_d	400	mW
Thermal Resistance Junction to Ambient	$R_{\theta jA}$	300	°C/W
Storage temperature	T_{stg}	-65~+125	°C

SK MAKE CONSCIOUS PRODUCT

CONSCIOUS PRODUCTS BEGIN WITH CONSCIOUS PEOPLE

Rev:06



www.shike.tw

ELECTRICAL CHARACTERISTICS @ Ta=25°C unless otherwise specified

Parameter	Symbol	Min.	Typ.	Max.	Unit	Conditions
Reverse Breakdown Voltage	$V_{(BR)R}$	40			V	$I_R=10\mu A$ $I_R=10\mu A$ $I_R=10\mu A$
Forward voltage	V_F			0.37 0.60	V	$I_F=20mA$ $I_F=200mA$
Reverse current	I_{RM}			5.0	μA	$V_R=30V$ $V_R=20V$ $V_R=10V$
Capacitance between terminals	C_T		50		pF	$V_R=0, f=1MHz$
Reverse Recovery Time	t_{rr}		10		ns	$I_R=I_F=200mA$ $I_{rr}=0.1*I_R, R_L=100\Omega$

TYPICAL CHARACTERISTICS

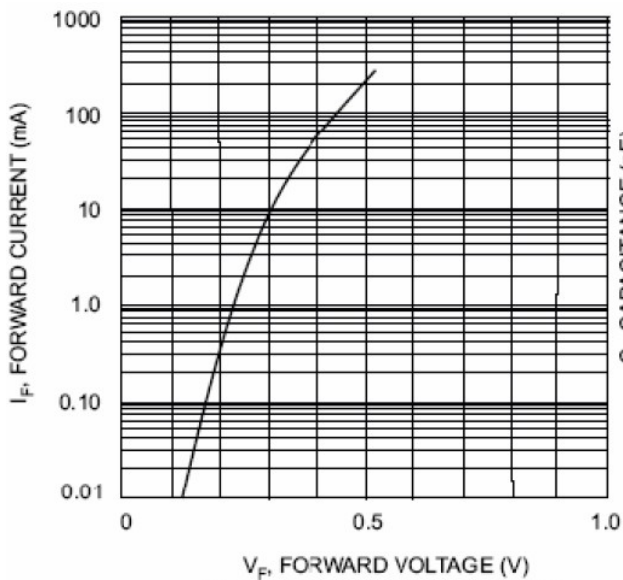

Fig. 1 Typical Forward Characteristics

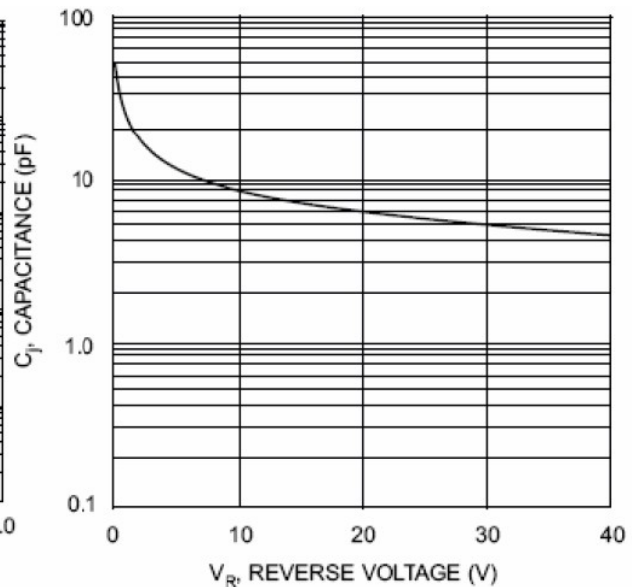

Fig. 2 Typ. Junction Capacitance vs Reverse Voltage

SK MAKE CONSCIOUS PRODUCT

CONSCIOUS PRODUCTS BEGIN WITH CONSCIOUS PEOPLE

Rev:06



www.shike.tw

PACKAGE OUTLINE

Plastic surface mounted package

SOD-323

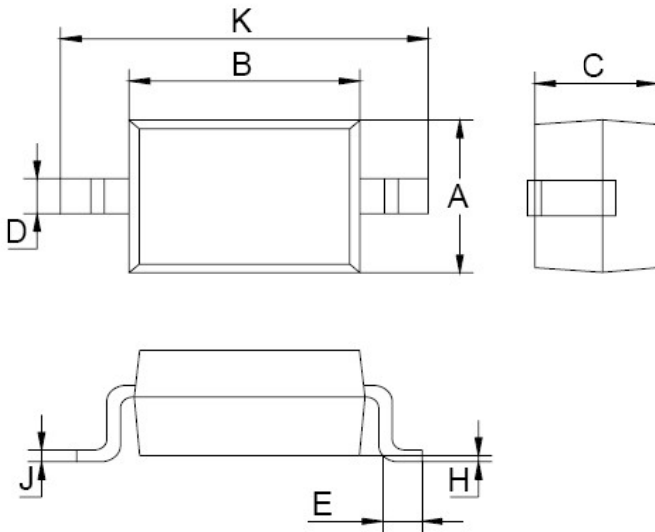

SOD-323		
Dim	Min	Max
A	1.275	1.325
B	1.675	1.725
C	0.9 Typical	
D	0.25	0.35
E	0.27	0.37
H	0.02	0.1
J	0.1 Typical	
K	2.6	2.7
All Dimensions in mm		

SOLDERING FOOTPRINT

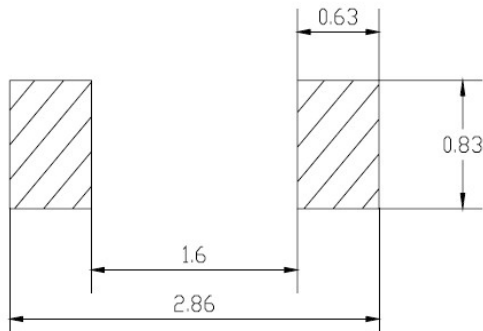

SK MAKE CONSCIOUS PRODUCT

CONSCIOUS PRODUCTS BEGIN WITH CONSCIOUS PEOPLE

Rev:06



www.shike.tw